

Modular Cooking Range Line
thermaline 90 -1000mm Passthrough
Warming Cabinet, 4 doors, GN conform,
2 Sides(H2) - H=550

ITEM # _____

MODEL # _____

NAME # _____

SIS # _____

AIA # _____

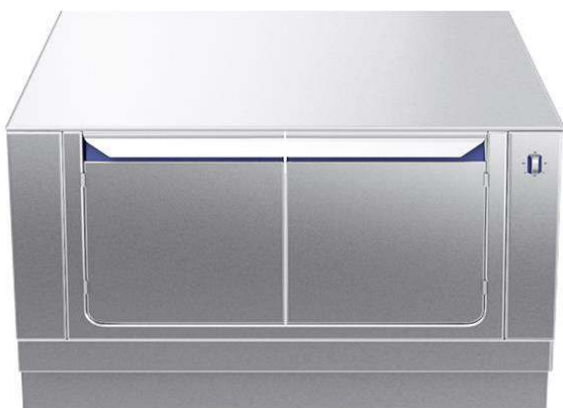

589494 (MC4KDCJOAO)

Passthrough electric
warming cabinet, with 4
doors, two-side operated,
GN - H2

Short Form Specification

Item No. _____

1000 mm wide passthrough warming cabinet with 4 doors, constructed according to DIN 18860_2 with 70 mm recessed plinth. Internal frame for heavy duty sturdiness in 2 mm and 3 mm in 1.4301 (AISI 304). 2 mm top in 1.4301 (AISI 304). Flat surface constructio

Main Features

- All major components may be easily accessed from the front.
- THERMODUL connection system creates a seamless work top when units are connected to each other thus avoiding soil penetrating vital components and facilitating the removal of units in case of replacement or service.
- Unit constructed according to DIN 18860_2 with 70 mm recessed plinth.
- Temperature in the cupboard can be set through a thermostat to suit different requirements. The maximum temperature is 110°C.
- [NOT TRANSLATED]

Construction

- IPX5 water resistance certification.
- 2 mm top in 1.4301 (AISI 304).
- Flat surface construction with minimal hidden areas to easily clean all surfaces
- Storage space in the base of the appliance accepts GN1/1 containers.
- Internal frame for heavy duty sturdiness in stainless steel.

APPROVAL: _____

Front

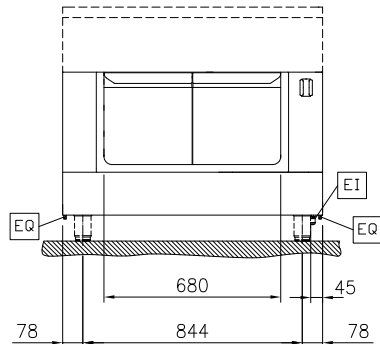

Side

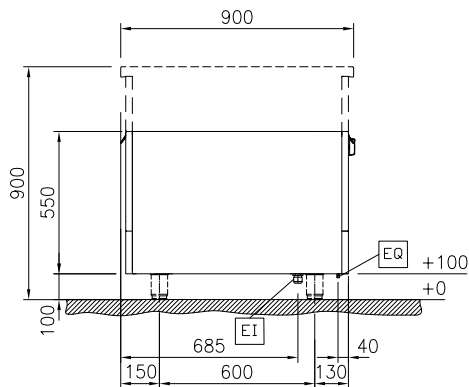

EI = Electrical inlet (power)

Top

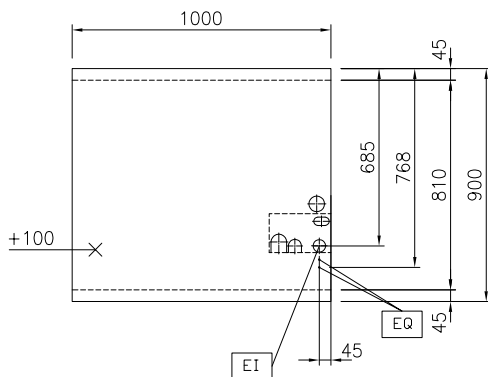

Key Information:

External dimensions, Width:	
589494 (MC4KDCJOAO)	1000 mm
External dimensions, Depth:	900 mm
External dimensions, Height:	550 mm
Cupboard Cavity Dimensions (width):	680 mm
Cupboard Cavity Dimensions (height):	330 mm
Cupboard Cavity Dimensions (depth):	810 mm
Cabinet temperature range:	30-110 °C
Net weight:	38 kg

Sustainability

Current consumption:	5 Amps
----------------------	--------



Electrolux
PROFESSIONAL

Modular Cooking Range Line
thermaline 90 -1000mm Passthrough Warming
Cabinet, 4 doors, GN conform, 2 Sides(H2) -
H=550

Optional Accessories

- Stainless steel side panel (12mm), 900x800mm, freestanding PNC 912511 ☐
- Stainless steel front kicking strip, 1000mm width PNC 912600 ☐
- Stainless steel side kicking strips left and right, freestanding, 900mm width PNC 912621 ☐
- Stainless steel plinth, freestanding, 1000mm width PNC 912922 ☐
- - NOT TRANSLATED - PNC 913238 ☐
- - NOT TRANSLATED - PNC 913244 ☐
- - NOT TRANSLATED - PNC 913259 ☐
- - NOT TRANSLATED - PNC 913284 ☐
- - NOT TRANSLATED - PNC 913673 ☐
- - NOT TRANSLATED - PNC 913676 ☐
- - NOT TRANSLATED - PNC 913689 ☐



Modular Cooking Range Line
thermaline 90 -1000mm Passthrough Warming Cabinet, 4 doors, GN
conform, 2 Sides(H2) - H=550
The company reserves the right to make modifications to the products
without prior notice. All information correct at time of printing.

2025.04.18